

# Sunco

Lighting made better.

User Manual

## 2x2 LED Selectable Ceiling Panel

SKU: PN22\_DU-WH-4060K

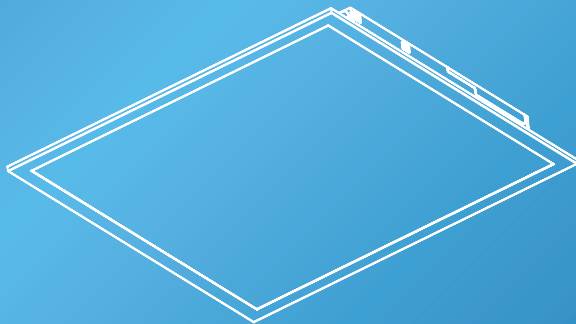

support@sunco.com  
(844) 334-9938



# What's in the Box?

## Ceiling Panel

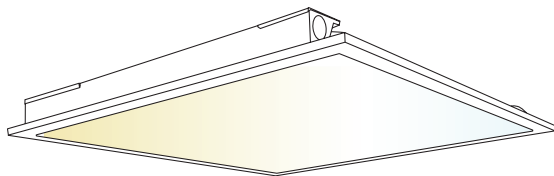

*Let there be light!  
(literally)*

## Accessories



Wire Nuts **x5**

## Get Your Gear (Not Included)

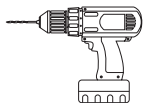

Drill



Hammer



Pliers

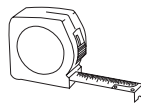

Tape Measure



Pencil



Phillips Screwdriver



Ladder



Leveler

# Before You Start

## Safety Information

### To reduce the risk of fire, electric shock, or physical injury:

- Turn off circuit breaker before installing this fixture.
- Suitable for use in wet environments at temperatures ranging from -4° to 113°F.
- Not for use where directly exposed to water.
- Not intended for use with emergency fixtures.
- Not compatible with photo controls.
- Not compatible with occupancy sensors.
- Not compatible with third party sensors.
- Not compatible with all dimmers. For more dimming information, please visit [www.sunco.com](http://www.sunco.com).
- Not compatible with timing devices.
- All electrical connections must be in accordance with local and National Electric Code (N.E.C.) standards.

- Please review installation manual carefully before proceeding. Consult a qualified electrician if you are unfamiliar with proper electrical wiring connections.

**This device complies with Part 15 of the FCC rules. Operation is subject to the following two conditions:**

- 1) This device may not cause harmful interference.**
- 2) This device must accept any interference that may cause undesired operation. Please review all instructions carefully prior to installation.**

### WARNING:

Cancer & Reproductive Harm- [www.P65Warnings.ca.gov](http://www.P65Warnings.ca.gov)

## Wiring Diagram

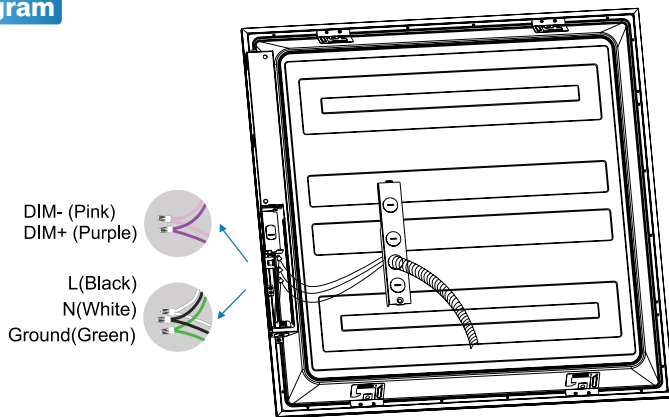

# Installation Guide (Recessed Mount)

## STEP 1

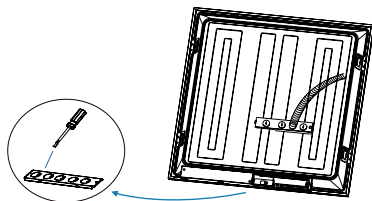

- Turn off circuit breaker before installation.
- Place ceiling panel face down on a flat surface. Unscrew the driver cover and set screws aside. Pop out knockouts (choice of 4).
- Optional: If using dimming wires, pop out an additional knockout of the four available knockouts.

## STEP 2

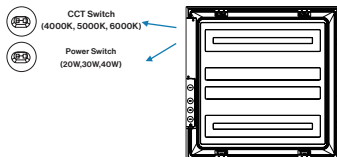

- Use the switches to select the wattage / CCT on the back of the ceiling panel.
- Connect the conduit to each knockout, then feed the wires through.

## STEP 3

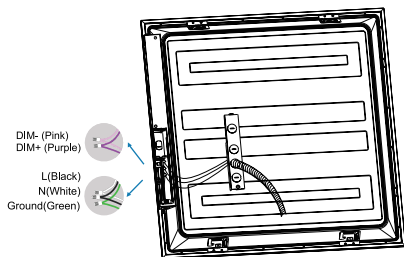

- Connect luminaire wires with supply wires using included wire nuts (A):
  - Black to Black (Live) • White to White (Neutral) • Green to Bare Copper (Ground)
- For wire connections with multiple hot wires (240/277V):
  - Black to Red (HOT1) • White to Red (HOT2) • Green to Bare Copper (Ground)
- Optional: Connect compatible device for dimming features. Otherwise, cap wires if dimmer is not being used.
  - Pink to Pink (DIM-) • Purple to Purple (DIM+)

## Installation Guide (Cont.)

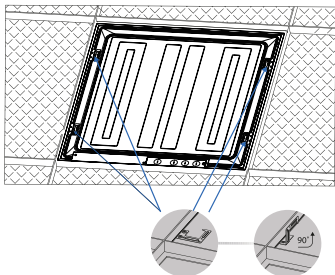

### STEP 4

- a. Bend 4 protective brackets located on back of Ceiling Panel up 90°.

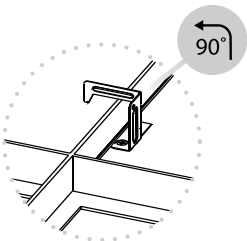

### STEP 5

- a. Turn brackets 90°. Hook should face outside edge of Ceiling Panel.

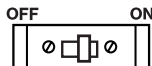
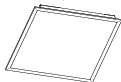
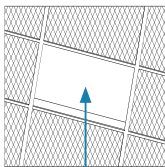

### STEP 6

- a. Install ceiling panel, then turn on circuit breaker to test light.

# Installation Guide (Suspension Mount)

## STEP 1

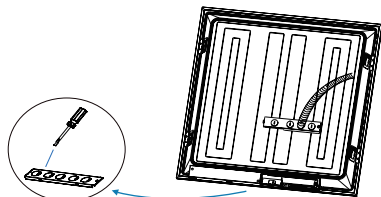

- Turn off circuit breaker before installation.
- Place ceiling panel face down on a flat surface. Unscrew the driver cover and set screws aside. Pop out knockouts (choice of 4).
- Optional: If using dimming wires, pop out an additional knockout of the four available knockouts.

## STEP 2

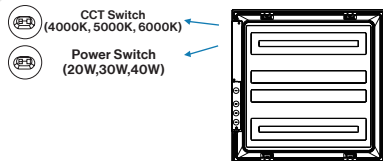

- Use the switches to select the wattage / CCT on the back of the ceiling panel.
- Connect the conduit to each knockout, then feed the wires through.

## STEP 3

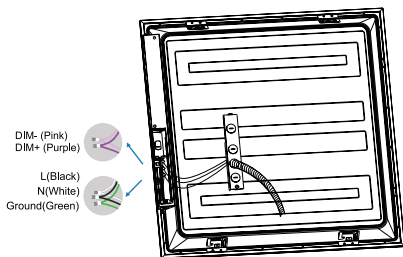

- Connect luminaire wires with supply wires using included wire nuts (A):
  - Black to Black (Live) • White to White (Neutral) • Green to Bare Copper (Ground)
- For wire connections with multiple hot wires (240/277V):
  - Black to Red (HOT1) • White to Red (HOT2) • Green to Bare Copper (Ground)
- Optional: Connect compatible device for dimming features. Otherwise, cap wires if dimmer is not being used.
  - Pink to Pink (DIM-) • Purple to Purple (DIM+)

## Installation Guide (Cont.)

### STEP 4

- Drill 4 holes into desired area of the ceiling.
- Insert plastic anchors (not included) into screw holes, insert wire rope (not included) and mounting screws (not included).

Note: Refer to suspension kit install manual (not included) for complete details.

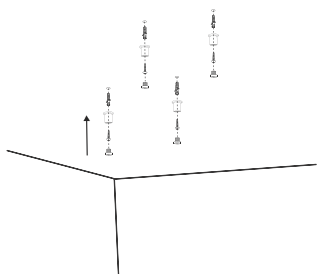

### STEP 5

- Adjust support rope / wire to ensure ceiling panel hangs horizontally and evenly.
- Adjust the light into the ceiling, then secure using protective brackets.
- Once ceiling panel is installed, turn on circuit breaker to test light.

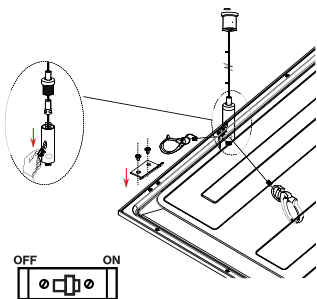

# Product Details

## Recommended Dimmers

Brand	Model
LUTRON	DVSTV-WH
LUTRON	NTSTV-DV
LUTRON	DVTV-WH
LEVITON	DS710-10Z
LEGRAND	RH4FBL3PTC

Scan for the full  
compatible dimmer list!



## Specifications

<b>Voltage</b>	120V-277V	<b>Average Lifetime</b>	50,000 Hours
<b>Wattage</b>	30W/35W/40W	<b>Lumens</b>	3500/4000/4500 lm
<b>Power Factor</b>	>0.9	<b>IP Rating</b>	IP20
<b>Beam Angle</b>	120°	<b>Material</b>	PET+SPCC
<b>CRI</b>	80+	<b>Efficacy</b>	110 lm/w
<b>Dimmable</b>	0-10V	<b>Warranty</b>	7 Years



# Common Troubleshooting

Feeling in the dark about an issue with your product? No worries! Our troubleshooting section is here to shed some light and provide you with easy-to-follow solutions for any problem.

If you still need some assistance, please feel free to contact us with any questions. Our team of lighting experts are happy to help brighten your day.

## Installation

Light isn't turning on.

Double check if fixture is properly connected and circuit breaker hasn't been tripped.

Light unexpectedly fails.

Reach out to customer support.

## Dimming

Light not dimming to lowest setting.

Ensure minimum dimmer load requirement is met.

Light not dimming smoothly.

Verify dimmer compatibility with fixture.

Light not compatible with dimmer switch.

Check light-dimmer compatibility. Consider purchasing compatible switch if necessary.

## Flickering

Light is flickering when turning on.

Check that fixture wiring connections are secure.

Light flickering with other lights on the same circuit.

Check that the lights on the same circuit are not overloading the circuit.

Light flickering when turned on.

Verify fixture compatibility and that it is grounded.

Light flickering when dimmed.

Verify dimmer switch compatibility.

## Buzzing

Fixture buzzing with power outages.

Verify light is connected to surge protector securely.

Fixture buzzing with appliances or electronic devices.

Look for nearby interferences that can cause buzzing. Such as televisions, radios, computers, etc.

Fixture buzzing when dimmed.

Verify dimmer switch compatibility.

# Sunco

Lighting made better.